

Operating Instructions and Parts Manual

Please read and save these instructions. Read through this owner's manual carefully before using product. Protect yourself and others by observing all safety information, warnings, and cautions. Failure to comply with instructions could result in personal injury and/or damage to product or property. Please retain instructions for future reference.

ENCLOSED PARTS WASHER WITH HEATING SYSTEM ---EPW160-H

EPW 160-H

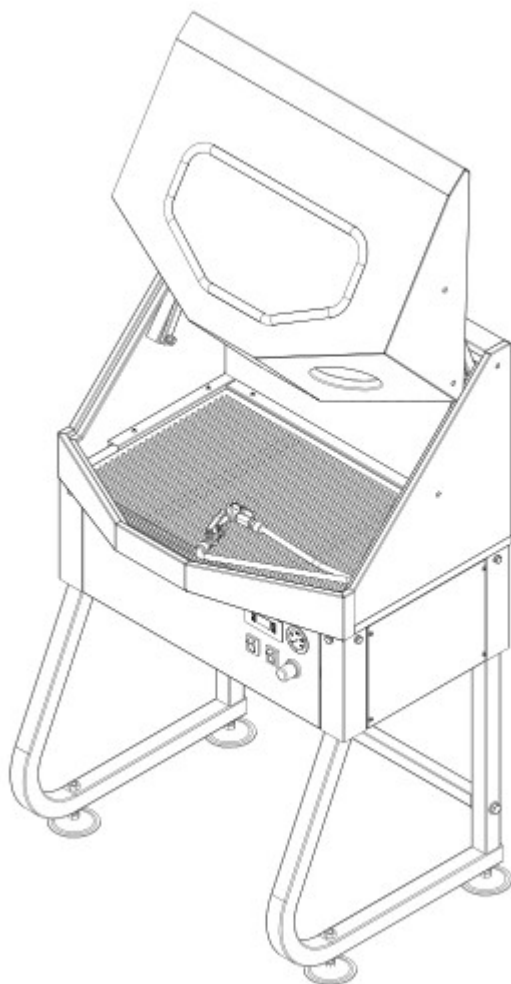

Description

- ◇ Parts washer in large enclosed cabinet with high protection from solvent, splash & odor.
- ◇ Pneumatic washing gun suitable for rapid cleaning.
- ◇ Auxiliary heating system supplying Max. 50 Celsius Degree solvent which highly increases cleaning efficiency.
- ◇ Fluorescent lighting system for bright view.
- ◇ External air fan brings excellent ventilation.
- ◇ Washing pressure: 70-120 PSI
- ◇ Washing recirculate flux: 0.8 Liter/min.
- ◇ Working area: 29*22*17.8 inch.
- ◇ Solvent capacity: 8-14 L.

ENCLOSED PARTS WASHER EPW 160-H

- ◇ Air requirement: 70-120 PSI@5CFM.

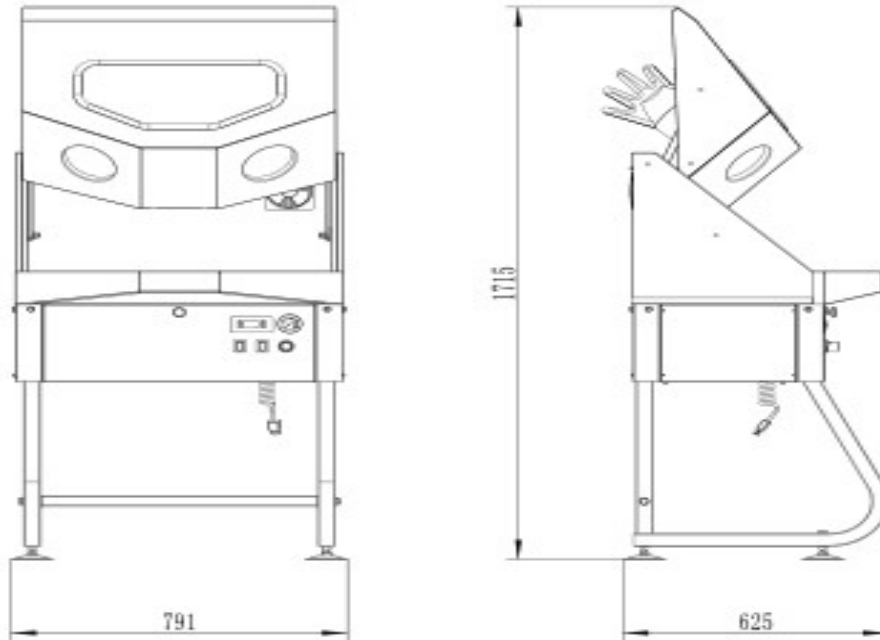

General Safety Information

▲WARNING

1. *Keep the working bench horizontal deviation less than 2 degree angle.*
2. **KEEP WORK AREA CLEAN.**
Cluttered areas and benches invite accidents.
3. **KEEP CHILDREN AWAY.** *All visitors should be kept a safe distance from work area.*
4. **USE THE RIGHT TOOL.** *Don't force parts washer or attachment to do a job for which it was not designed for*
5. **Equip with our authorized hose parts while using ORGANIC CLEANING SOLVENT.**
6. **USE PROTECTIVE GLOVES.** *Do not use broken gloves.*
7. **DISCONNECT PARTS WASHER** *before servicing and when changing accessories.*
8. **MAKE SURE HEATING SWITCH IS "OFF"** *before you start the machine.*
9. **DO NOT START HEATING** *when the volume of solvent is lower than 8 liters.*
10. **DO NOT OPERATE WHEN CABINET COVER IS OPEN.**
11. **DO NOT USE SOLVENT WHICH IGNITION TEMPERATURE IS LOWER THAN 120 DEGREE CELCIUS.**
12. **DO NOT SET OPERATING TEMPERATURE higher than 50 degree Celsius.**

ENCLOSED PARTS WASHER EPW 160-H

Parts Washer Contents

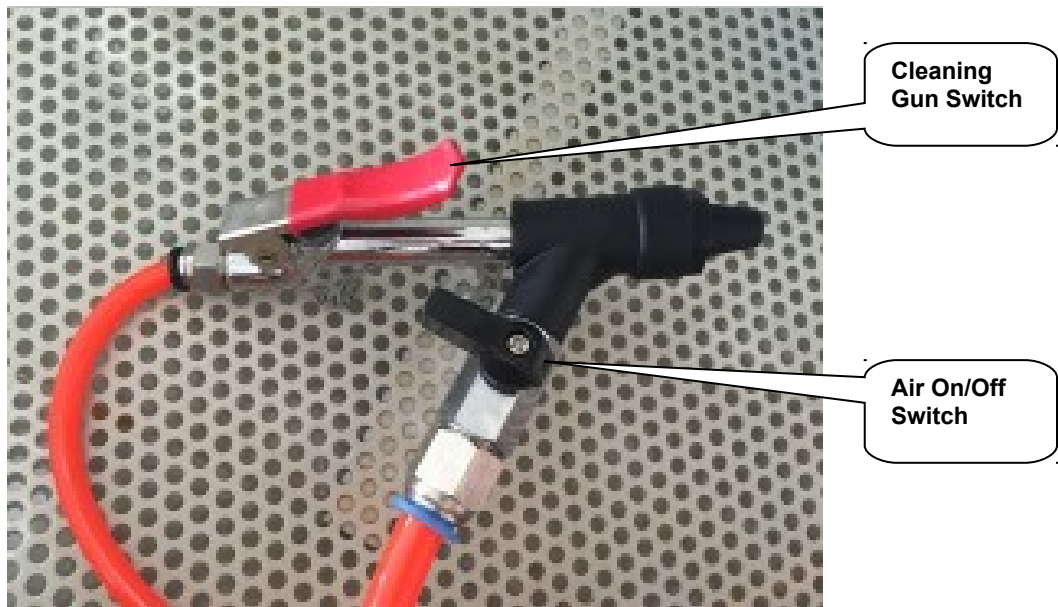
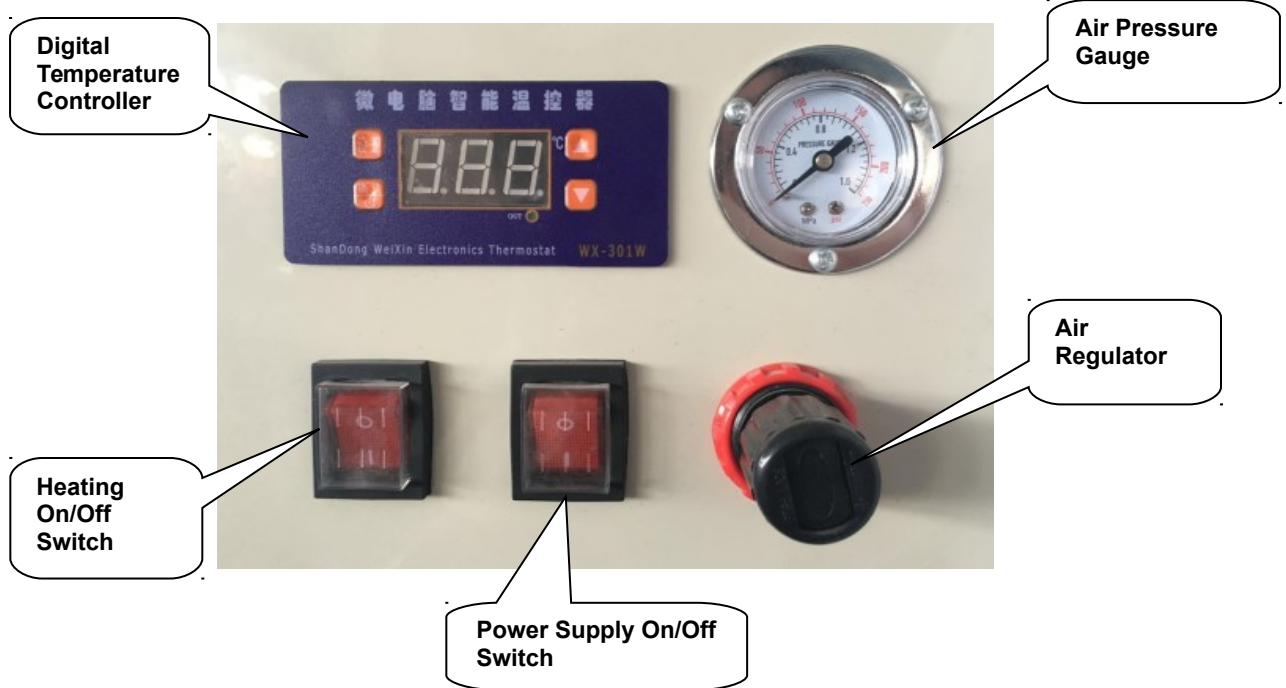

ENCLOSED PARTS WASHER EPW 160-H

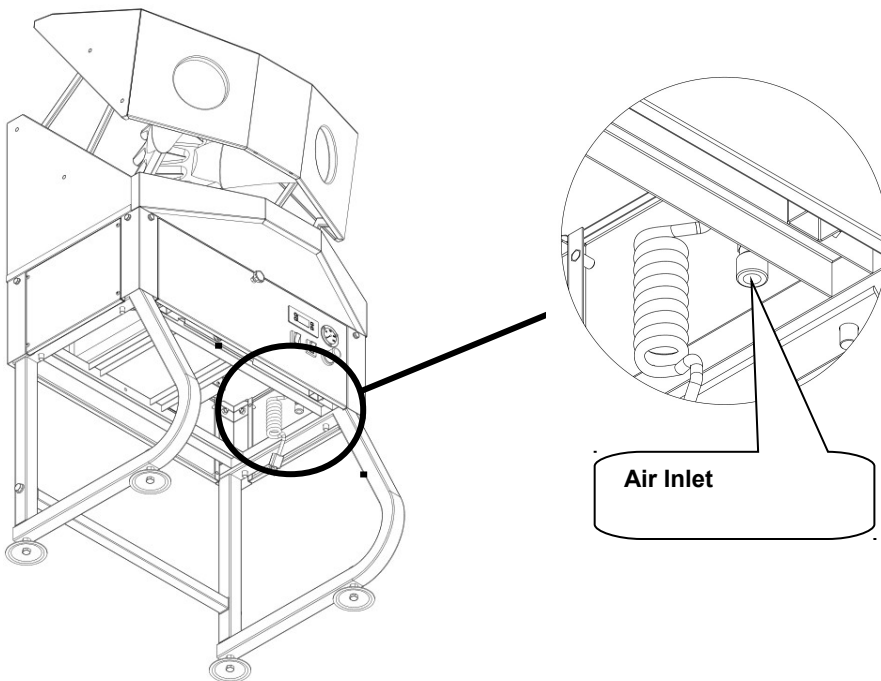
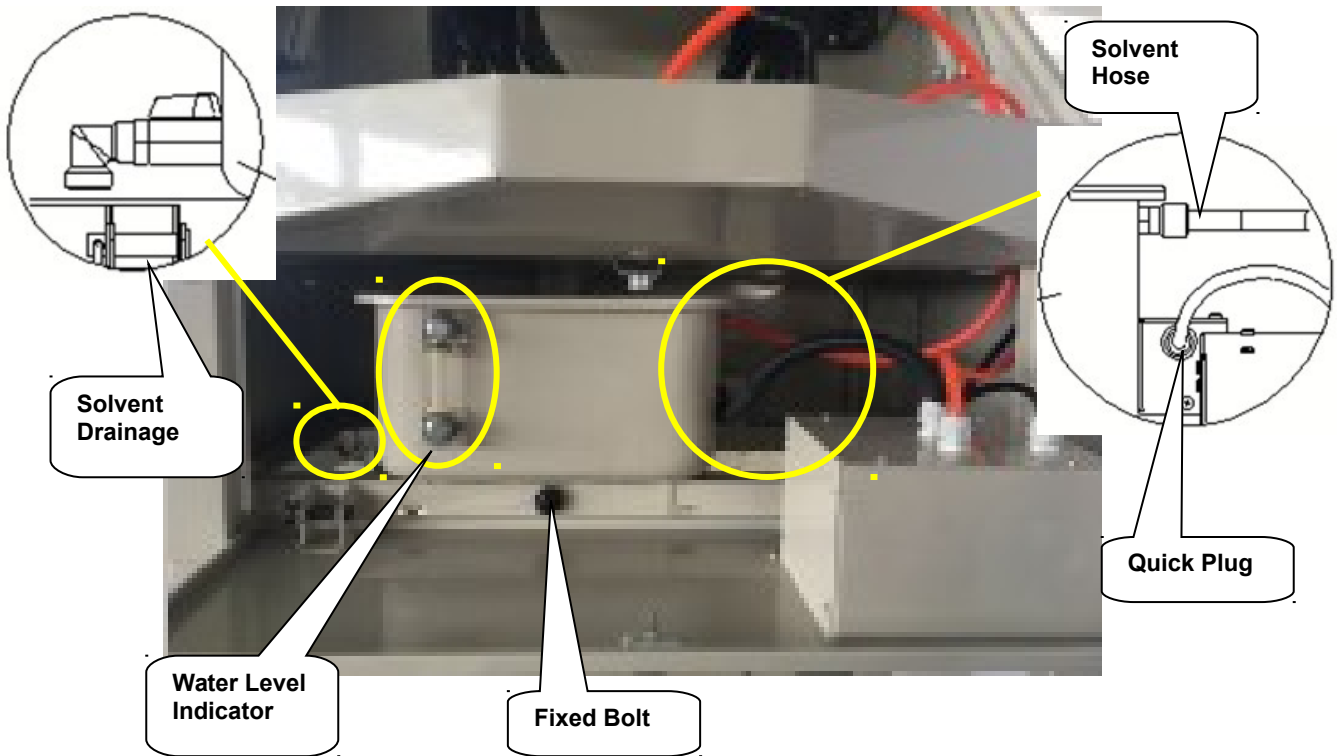

ENCLOSED PARTS WASHER EPW 160-H

Water Level Indicator: To observe whether or not more solvent is needed

Air Inlet: To connect with air compressor using $\varnothing 8$ hose

Air Regulator: Adjust appropriate air pressure based on the parts type you are washing.

Digital Temperature Controller: Adjust the setting temperature. (Details in temperature control instruction).

Air Pressure Gauge: Indicates air inlet pressure

Power Supply On/Off Switch: Turn on the switch for LED light & Ventilated fan electric supply
Heating On/Off Switch: Turn on the switch for solvent heating.

Cleaning Gun Switch: Press cleaning gun switch to clean parts with water/solvent.

Air On/Off Switch: Turn on the black switch for air drying.

Solvent Drainage: Use water outlet to get dirty solvent out.

Solvent Hose: Connect with cleaning gun and tank.

Fixed Bolt: Fixes tank to the frame

ENCLOSED PARTS WASHER EPW 160-H

Assembly

Assembly Accessories:



1. Lay down cabinet and connect 2 support legs (23) with cabinet using 4 M12 Screws and Flat Washers.
2. Attach Leg Reinforcers (22) to support legs (23) using 2 M10 Screws and Flat Washers.
3. Attach 4 foot pads (24) to the bottom of support legs (23).
4. Turn the machine over and adjust the height of foot pad
5. Tighten all fasteners.

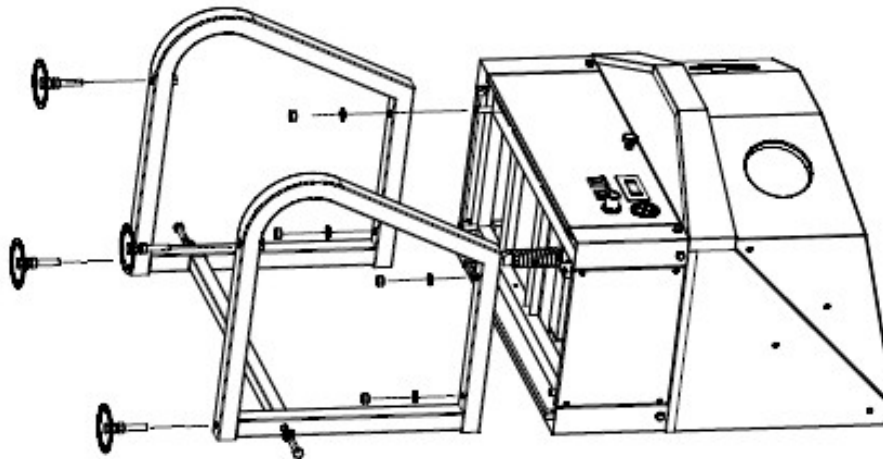

ENCLOSED PARTS WASHER EPW 160-H

Operation Notice

1. **Adding Solvent:** Open cabinet cover, add solvent through the web. Minimum 8L , maximum 14 liters. Observe the water level indicator.
2. **Compressed Air Connect:** Connect the air compressor $\phi 8$ hose with the quick fitting at the bottom of the cabinet. Adjust appropriate air pressure based on the parts type you are washing.
3. **LED light & ventilated fan:** Plug parts washer into an electric power supply, turn on **Power Supply On/Off Switch for LED light & ventilated fan**. Adjust the setting temperature.
4. **Solvent Temperature Setting:** Set **Digital Temperature Controller for solvent heating**. (Details in temperature control instruction).
5. **Cleaning:** Put parts into the machine and close the door, using cleaning gun to wash and air drying.
6. **Finishing:** Make sure to turn off **Heating On/Off Switch, also Power Supply On/Off Switch after finished**.

Maintenance

NOTE: Disconnect power and air before the maintenance. Replace the solvent when needed.

Cleaning: Clean the solvent filter screen (7) regularly in case of clogging.

Solvent Changing: Use water outlet to get dirty solvent out from tank. Twist $\phi 12$ Water Suction Faucet and fixed bolt off to take out tank for cleaning.

Wiring Diagram

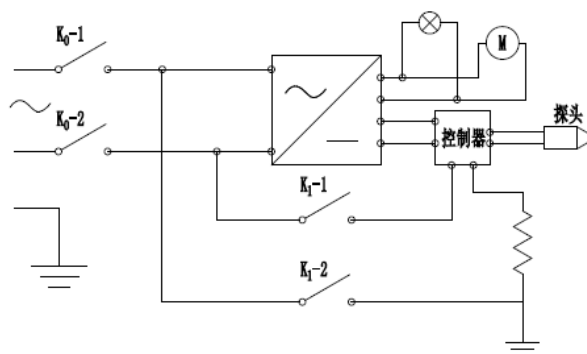

ENCLOSED PARTS WASHER EPW 160-H

Troubleshooting Chart

Symptom (s)	Possible Causes(s)	Corrective Action(s)
Cleaning gun only works with air, no solvent usage	<ol style="list-style-type: none"> 1. Cleaning switch is OFF 2. Inadequate solvent 3. Absorption pipe is blocked 	<ol style="list-style-type: none"> 1. Turn it on 2. Add more solvent into the tank. 3. Check and clean the absorption pipe.
Light doesn't work but fan still works	<ol style="list-style-type: none"> 1. Light is broken 	<ol style="list-style-type: none"> 1. Replace bulb
Fan doesn't work but light still works	<ol style="list-style-type: none"> 1. Fan is broken 	<ol style="list-style-type: none"> 2. Pull out waterproof plug and replace with new fan
Temperature controller display abnormal	<ol style="list-style-type: none"> 1. Possible loose connection 	<ol style="list-style-type: none"> 1. Double check the connection
Temperature cannot reach to what you set	<ol style="list-style-type: none"> 1. Inadequate solvent 2. Heating On/Off Switch is OFF 3. Heating tube is broken 	<ol style="list-style-type: none"> 1. Add more solvent 2. Turn on the Heating On/Off Switch 3. Replace with new heating tube
If washer does not remain on and heating	<ol style="list-style-type: none"> 1. Factory reset is required 	<ol style="list-style-type: none"> 1. Make sure "F8: is set to "off" then hold "Set" button until it beeps

ENCLOSED PARTS WASHER EPW 160-H

Explosive View

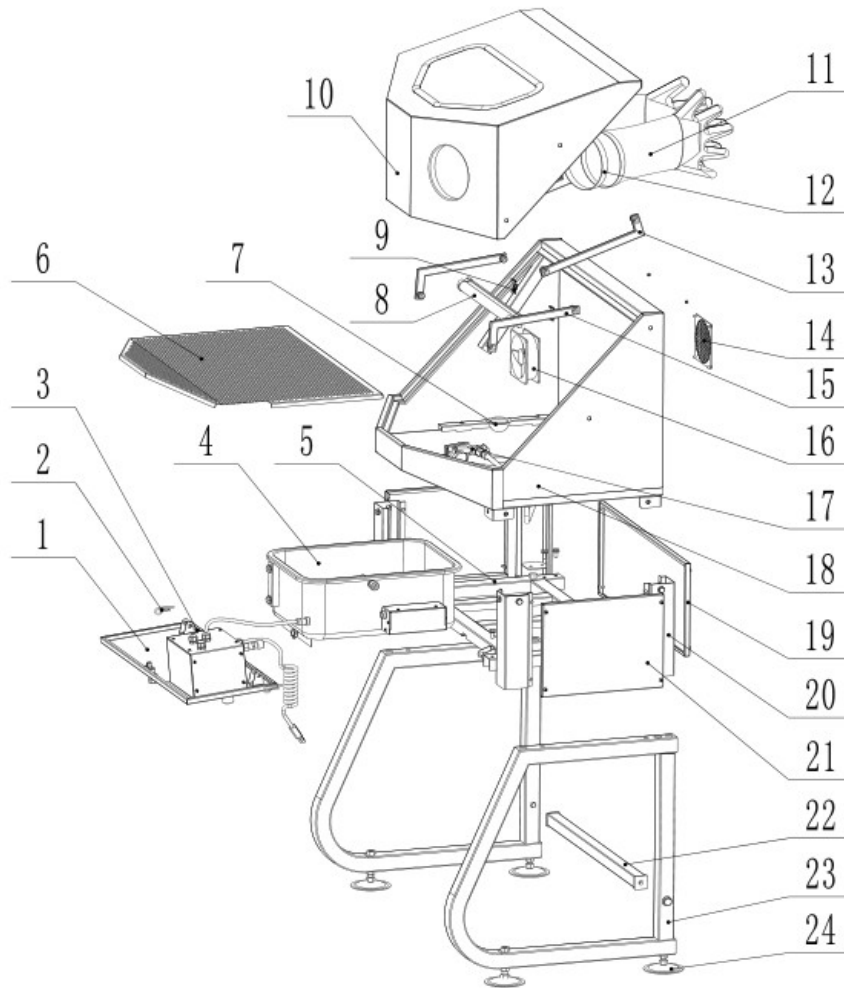

ENCLOSED PARTS WASHER EPW 160-H

Parts

Part No.	Description	Qty.
1	Front Panel	1
2	Pin	2
3	Hinge Axis	2
4	Cleaning Tank	1
5	Cabinet Holder	1
6	Web	1
7	Filter Screen	1
8	LED Light	1
9	Light Hoop	2
10	Cabinet Cover	1
11	Gloves	1 pair
12	Gloves Hoop	2
13	Back Door Rod	2
14	Fan Cover	1
15	Front Door Rod	2
16	Ventilated Fan	1
17	Cleaning Gun	1
18	Cabinet	1
19	Back Protective Shield	1
20	Side Support	4
21	Side Protective Shield	2
22	Leg Reinforces	1
23	Support Leg	2
24	Foot Pad	4

ENCLOSED PARTS WASHER EPW 160-H



THERMOSTAT INSTRUCTION

1. Press “ON”, turn on the digital meter indicating real-time temperature.
2. How to set heating temperature?
 - a. Short press ”Set”, the temperature number starts blinking.
 - b. Press  , Up / Increase Temperature & Down / Decrease Temperature.
 - c. Press “OK”, Done.
3. How to set “Heating” & “Freezing”?
 Our parts washer is only available with heating function, so this step is normally no use.

a. Long press “Set”, F0 indicate,

b. Short press “Set“, “C” or “H” indicate



- c. Press  , choose “C” or “H” d. Press “OK”, Done.
- “C” means freezing. “H” means heating

4. Code Reference:

ENCLOSED PARTS WASHER EPW 160-H

a. Long press “Set” F0 indicate,

b. Long press “Set“ Again to F1

c. Press  choose “F0” -- “F8”

d. Press “OK”

CODE	FUNCTION	SET RANGE
F0	HEATING SET	H/C
F1	TEMPERATURE RETURN DIFFERENCE	0.1-30
F2	N/A	N/A
F3	N/A	N/A
F4	TEMPERATURE CALIBRATION	-10~ +10°C
F5	DELAY STARTING	0~10 Mins
F6	OVERHEATING ALARM	-55~120 °C
F7	DATA LOCK	ON/OFF
F8	DEFAULT	ON/OFF